

# THE CLEAR ALTERNATIVE TO BLIND D&C



TruClear™ System

# VISUAL D&C: INCREASING YOUR ASSURANCE IN A FAMILIAR PROCEDURE

Over 100,000 blind D&Cs are performed each year in America alone; however research has shown them to have low diagnostic accuracy. In a study of post-menopausal women, whole or parts of the lesion remained in situ after a D&C in 87 percent of patients.<sup>1</sup>

The TruClear™ system can provide you with direct visualization of the uterine cavity and efficient tissue removal. It will also deliver the assurance you have captured all the tissue you need for pathological analysis.



**87%** vs. **2%**  
**OF LESIONS REMAIN**      **OF LESIONS REMAIN**

After a **blind D&C**, whole or part of the lesion remained in situ in 87 percent of patients, in a study of post-menopausal women.<sup>1</sup>

After a procedure with the **TruClear™ system**, whole or part of the lesion remained in situ in only 2% of patients, in a randomized controlled trial.<sup>2</sup>

## When you bring the TruClear™ system to your office or OR, you get a device that:

- Resects pathology down to base with the close-cutting edge of TruClear™ soft tissue devices
- Allows complete tissue capture for histological confirmation through simultaneous cutting and aspiration
- Is designed to reduce trauma to surrounding healthy endometrium
- Is associated with a lower rate of intrauterine adhesions than a metal curette<sup>3</sup>
- Aligns with ACOG guidance: hysteroscopy is recommended with directed D&C to include any discrete lesions as well as the background endometrium<sup>4</sup>

# COMPLETE MORE CASES WITH GREATER ACCESS.

With its open cutting window design, the rotary-style TruClear™ soft tissue devices offer unimpeded access to all pathology within the cavity. By comparison, reciprocating-style devices may not be able to adequately reach pathology in all areas of the uterus.



## ROTARY-STYLE DEVICE



**Enables access to entire cavity,** including the cornua and fundal wall



**Provides gentle resection** all the way down to the base of the pathology



**Optimized for soft-tissue removal,** the only blade-style designed to draw in tissue

## RECIPROCATING- STYLE DEVICE

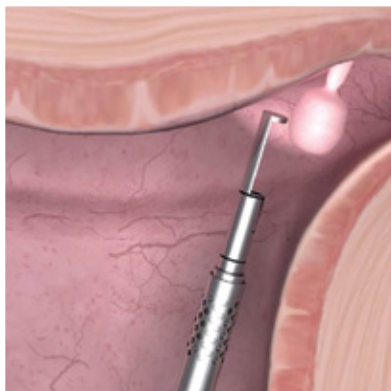

# THE CLEAR ADVANTAGE



1 mm distal cap

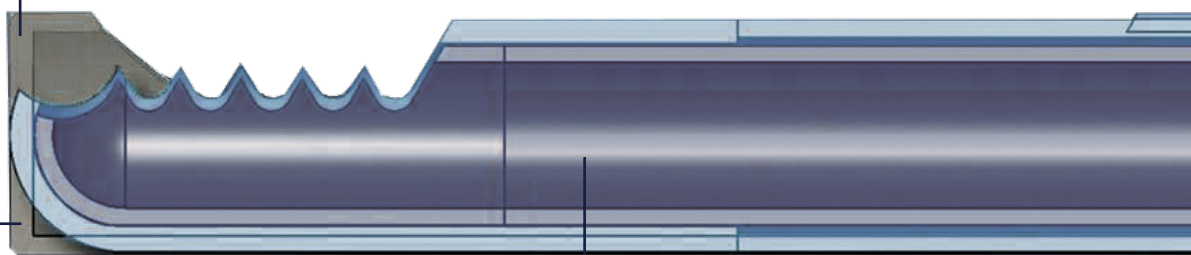

Reciprocating-style device

Rotary-style device

CAD depiction of the TruClear™ soft tissue shaver mini overlaid with a reciprocating device that has a 1 mm distal cap. Dimensions and representations of reciprocating device may not be accurate.

1. Epstein E, Ramirez A, Skoog L, Valentin L. Dilatation and curettage fails to detect most focal lesions in the uterine cavity in women with postmenopausal bleeding. *Acta Obstet Gynecol Scand.* 2001;80(12):1131–1136.
2. Smith PP, Middleton LJ, Connor M, Clark TJ. Hysteroscopic morcellation compared with electrical resection of endometrial polyps. *Obstet Gynecol.* 2014;123(4):745–751.
3. Rein DT, Schmidt T, Hess AP, Volkmer A, Schöndorf T, Breidenbach M. Hysteroscopic management of residual trophoblastic tissue is superior to ultrasound-guided curettage. *J Minim Invasive Gynecol.* 2011;18(6):774–778.
4. American College of Obstetricians-Gynecologists. ACOG practice bulletin: Clinical management guidelines for obstetrician-gynecologists. Number 149, April 2015. *Obstet Gynecol.* 2015;125(4):1010.

TruClear™ system is a Medtronic product. Product packaging and labeling reflect Covidien. Covidien is a subsidiary of Medtronic.

Photo credit: iStock

For more information about the TruClear™ system, including indications for use, contraindications, effects, precautions, and warnings, please consult the instructions for use (IFU) for the product.

## Medtronic

IMPORTANT: Please refer to the package insert for complete instructions, contraindications, warnings and precautions.

© 2019 Medtronic. All rights reserved. Medtronic, Medtronic logo and Further, Together are trademarks of Medtronic.™\*\* Third party brands are trademarks of their respective owners. All other brands are trademarks of a Medtronic company. 19-weu-truclear-vs-d-c-brochure-2933260

[medtronic.com/covidien/en-gb/index.html](https://www.medtronic.com/covidien/en-gb/index.html)